



ISO A - ISO B - Standard
ISO A - ISO B - Standard
ISO A - ISO B - Standard
ISO A - ISO B - Standard

Agriculture
Agricoltura
Ausführung Agritechnik
Agriculture

Screw Together
Innesti a vite
Schraubkupplungen
A Visser

Check Valves
Valvole Unidirezionali
Clapet Anti-retour

Diagnostic
Diagnostici
Diagnostik Kupplung
Diagnostik



Flat Face
Innesti Faccia Piana
Flachdichtend
Clapet a Face Plat



Multifaster
Multiconnessioni
Multikupplungen
Multifaster

Features 	Caratteristiche 	Merkmale 	Caractéristiques 
Connexion by screwing together the two parts	Connessione avvitando maschio e femmina	Verbindung durch Verschrauben der beiden Teile	Connexion en dévissant les deux parties
Disconnexion by unscrewing the two parts	Disconnessione svitando maschio e femmina	Entkuppeln durch Abschrauben	Déconnexion en dévissant les deux parties
Shut off by poppet valve	Sistema di tenuta mediante valvola a funghetto	Verschluß durch Kegelventil	Système d'étanchéité à clapet standard
Connectable under residual pressure	Innestabile con pressione residua	Kuppelbar unter Restdruck	Connectable sous pression résiduelle
Disconnexion under residual pressure	Disconnessione con pressione residua	Entkuppelbar unter Restdruck	Déconnexion avec une pression résiduelle
Interchangeability German Market	Intercambiabilità mercato Tedesco	Austauschbarkeit deutschen Markt	Interchangeabilité marché Allemand

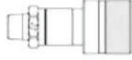
Fields of application
Settori di applicazione
Anwendungsbereiche
Domaines d'application

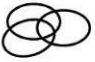
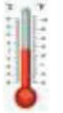

Size Base BG Taille		Working pressure Pressione di esercizio Betriebsdruck Pression de service	Flow Rate Portata Durchsatz Débit	Burst Pressures Pressione di scoppio Berstdruck Pression d'éclatement		
			@ 0,2 MPa pressure drop			
mm	inch.	MPa (PSI)	l/min (GPM)	MPa (PSI)	MPa (PSI)	MPa (PSI)
6.3	1/4"	103 (14935)	15 (3.96)	350 (50750)	310 (44950)	330 (47850)
10	3/8"	100 (14500)	20 (5.28)	350 (50750)	310 (47850)	300 (43500)

Technical Specifications	Specifiche Tecniche	Technischen Daten	Caractéristiques Techniques
 High grade carbon steel with heat treated wear parts.	Acciaio ad alto tenore di carbonio con parti sollecitate, trattate termicamente	High Quality Karbonstahl Induktionsgeärtet in besonders beanspruchter Stress zone	Acier à haute teneur en carbone avec traitement thermique des pièces d'usure
 NBR Backup ring in PTFE	NBR Anello antiestrusione PTFE	NBR Stützring in PTFE	NBR Anneau anti-extrusion en PTFE
 -25°C to +125°C (-13°F to +257°F)	-25°C a +125°C (-13°F a +257°F)	-25°C to +125°C (-13°F to +257°F)	-25°C à +125°C (-13°F à +257°F)
 Mate500 [®]	Mate500 [®]	Mate500 [®]	Mate500 [®]
 According to ISO 7241-2	Secondo la norma ISO 7241-2	Nach ISO 7241-2	Selon la norme ISO 7241-2

PVVM

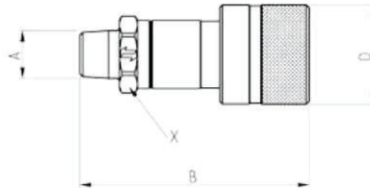

Female - Femmina - Muffe - Femelle

Size Base BG Taille	Thread Filetto Anschluss Filetage	Part Number Codice Articolo Artikelnummer Désignation	A	B	D	L	P	X	Weight Peso Gewicht Poids	Package Confezione Verpackung Colis
mm	inch.		mm (in)	mm (in)	mm (in)	mm (in)	mm (in)	mm (in)	g (lbs)	No.
6.3	1/4"	F PVVM 1/14 NPT F	1/4" NPTF Male	63 (2.48)	30 (1.18)			21 (0.83)		
10	3/8"	F PVVM 1/38 NPT F	3/8" NPTF Male	84 (3.31)	36 (1.42)			25 (0.98)		

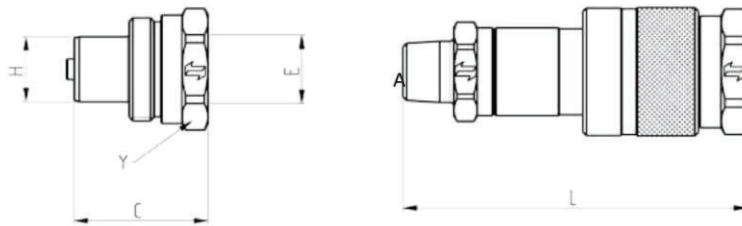

Male - Maschio - Stecker - Male

Size Base BG Taille	Thread Filetto Anschluss Filetage	Part Number Codice Articolo Artikelnummer Désignation	E	C	H	L	Y	Weight Peso Gewicht Poids	Package Confezione Verpackung Colis
mm	inch.		mm (in)	mm (in)	mm (in)	mm (in)	mm (in)	g (lbs)	No.
6.3	1/4"	1/ PVVM 14 NPT M	1/4" NPTF Female	34 (1.34)	15,8 (0.62)	B+C-19 (0.75)	27 (1.06)		
10	3/8"	1/ PVVM 38 NPT M	3/8" NPTF Female	39 (1.54)	19 (0.75)	B+C-25 (0.98)	27 (1.26)		

Accessories - Accessori - Zubehör - Accessoires

Size Base BG Taille	Dust protections Tappi Protezione Staubschutzteile Capuchons	Dust protections Tappi Protezione Staubschutzteile Capuchons	Seal Kits Guarnizioni di ricambio Ersatzdichtungen Joints	Package Confezione Verpackung Colis
mm	inch	Part Number Codice Articolo Artikelnummer Désignation	Part Number Codice Articolo Artikelnummer Désignation	
6.3	1/4"	TFP 14	TMP 14	SK PVVM 14
10	3/8"	TFP 38	TMP 38	SK PVVM 38

*10 O'rings + 10 PTFE rings

Thread Filetto Anschluss Filetage

