

VF

VFB



ISO A - ISO B - Standard
ISO A - ISO B - Standard
ISO A - ISO B - Standard
ISO A - ISO B - Standard

Agriculture
Agricoltura
Agriculture
Agriculture

Screw Together
Innesti a Vite
Schraubkupplungen
A Visser

Check Valves
Valvole Unidirezionali
Rückschläventile
Clapet Anti-retour

Diagnostic
Diagnostici
Diagnostik Kupplung
Diagnostic

Flat Face
Innesti Faccia Piana
Flachdichtend
Clapet à Face Plat

Multifaster
Multiconnessioni
Multikupplungen
Multifaster

Features	Caratteristiche	Merkmale	Caractéristiques
Connexion by pulling back the sleeve	Connessione mediante arretramento ghiera parte femmina	Kuppeln durch Einstecken des Kupplungssteckers	Connexion en poussant le coupleur mâle
Disconnexion by pulling back the female sleeve	Disconnessione mediante arretramento ghiera parte femmina	Entkuppeln, durch Zurückziehen der Verriegelungshülse	Déconnexion en en tirant la bague femelle
Shut off by flat valve	Sistema di tenuta mediante valvola piana	Verschluss durch flachdichtendes Ventil	Clapet à Face Plate
Connexion under pressure not allowed	Connessione in pressione non consentita	Kuppeln unter Druck nicht erlaubt	Connexion sous pression non autorisée
Disconnexion under pressure not allowed	Disconnessione in pressione non consentita	Entkuppeln unter Druck nicht erlaubt	Déconnexion sous pression non autorisée
Interchangeability according to ISO 5676	Intercambiabilità secondo norme ISO 5676	Austauschbarkeit gemäß ISO 5676 Standard	Interchangeabilité selon ISO 5676
No spillage during Connexion and Disconnexion	Assenza di spillaggio durante connessione e disconnessione	Kein Leakage während des Kuppel und Entkuppelvorgangs	Pas fuites lors de la connexion et la déconnexion

Fields of application
Settori di applicazione
Anwendungsbereiche
Domaines d'application



Size Base BG Taille		Working pressure Pressione di esercizio Betriebsdruck Pression de service	Flow Rate Portata Durchsatz Débit	Burst Pressures Pressione di scoppio Berstdruck Pression d'éclatement		
VF			@ 0,2 MPa pressure drop			
mm	inch.	MPa (PSI)	l/min (GPM)	MPa (PSI)	MPa (PSI)	MPa (PSI)
10	3/8"	22 (3175)	40 (10.5)	110 (24200)	90 (13050)	90 (13050)
VFB			@ 0,2 MPa pressure drop			
mm	inch.	MPa (PSI)	l/min (GPM)	MPa (PSI)	MPa (PSI)	MPa (PSI)
10	3/8"	25 (3625)	50 (13.2)	100 (14500)	100 (14500)	100 (14500)

Technical Specifications	Specifiche Tecniche	Technische Daten	Caractéristiques Techniques
	FEMMINA: in acciaio con parti sollecitate carbonitrate. MASCIO: in acciaio al carbonio temprato ad induzione	MUFFE: Hochwehtiger Karbonnitritstahl in besonders beanspruchten Zonen. STECKER: Hochwehtiger Karbonstahl induktionsgehärtet	FEMELLE: Acier avec le zones d'usure carbonitrided. MALE: acier à haute teneur trempés par induction
	NBR Anello antiestrusione PTFE	NBR Stützring in PTFE	NBR Anneau anti-extrusion en PTFE
	-25°C to +125°C (-13°F to +257°F)	-25°C a +125°C (-13°F a +257°F)	-25°C à +125°C (-13°F à +257°F)
	Mate500®	Mate500®	Mate500®
	Secondo la norma ISO 7241-2	Nach ISO 7241-2	Selon la norme ISO 7241-2

VF VFB

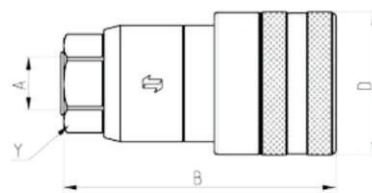
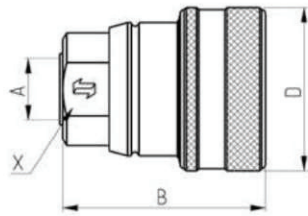

Female – Femmina – Muffe – Femelle:

Size Base BG Taille	Thread Filetto Anschluss Filetage	Part Number Codice Articolo Artikelnummer Désignation	A	B	D	P	X / Y	Weight Peso Gewicht Poids	Package Confezione Verpackung Collis
mm	inch.			mm (in)	mm (in)	mm (in)	mm (in)	g (lbs)	No.
10	3/8"	F	VF 38 GAS F	3/8" BSP Female	55 (2.16)	44 (1.73)		27 (1.06)	15
10	3/8"	F	VF 1815 F	M18x1.5 Female	55 (2.16)	44 (1.73)		27 (1.06)	15
10	3/8"	O	VF 0/12 GAS F	3/8" BSP Female O'Ring	59 (2.32)	44 (1.73)		27 (1.06)	15
10	3/8"	F	VFB 38 GAS F	3/8" BSP Female	84 (3.31)	44 (1.73)		27 (1.06)	15
10	3/8"	F	VFB 12 GAS F	1/2" BSP Female	84 (3.31)	44 (1.73)		27 (1.06)	15
10	3/8"	F	VFB 1815 F	M18x1,5 Female	84 (3.31)	44 (1.73)		27 (1.06)	15

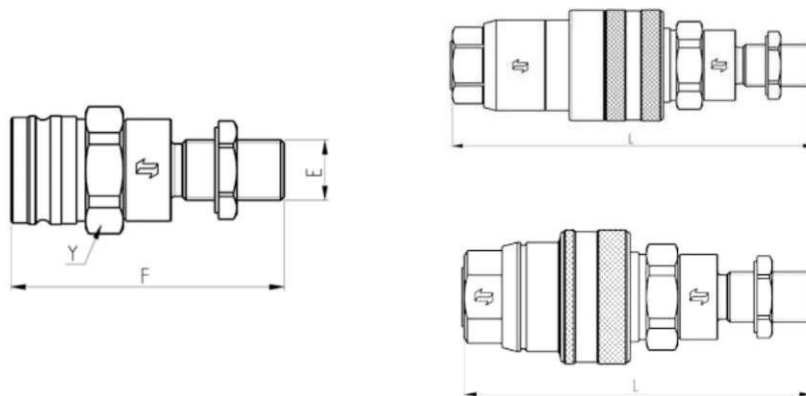

Male – Maschio – Stecker – Male :

Size Base BG Taille	Thread Filetto Anschluss Filetage	Part Number Codice Articolo Artikelnummer Désignation	E	C	L	P	Y	Weight Peso Gewicht Poids	Package Confezione Verpackung Collis
mm	inch.			mm (in)	mm (in)	mm (in)	mm (in)	g (lbs)	No.
10	3/8"	1/	VF 1/12 GAS M	1/2" BSP Male	59 (2.32)	B+C -22 (0.87)	32 (1.06)		25
10	3/8"	5/	VF 5/2215 M	M22x1.5 Male 15L	59 (2.32)	B+C -22 (0.87)	35 (1.38)	32 (1.06)	25
10	3/8"	7/	VF 7/1815 M	M18x1.5 Male 12L	52 (2.05)	B+C -22 (0.87)	26 (1.02)	32 (1.06)	25
10	3/8"	8/	VF 8/2015 M	M20x1.5 Male 12S	54 (2.13)	B+C -22 (0.87)	35 (1.38)	32 (1.06)	25
10	3/8"	9/	VF 9/1615 M	M16x1.5 Male 10L	54 (2.13)	B+C -22 (0.87)		32 (1.06)	25
10	3/8"	9/	VF 9/1815 M	M18x1.5 Male 12L	54 (2.13)	B+C -22 (0.87)		32 (1.06)	25

ISO A - ISO B - Standard
ISO A - ISO B - Standard
ISO A - ISO B - Standard
ISO A - ISO B - Standard

Agriculture
Agricoltura
Ausführung Agritechnik
Agriculture

Screw Together
Innesti a Vite
Schraubkupplungen
A Visser

Check Valves
Valvole Unidirezionali
Rückschventile
Clapet Anti-retour

Diagnostic
Diagnostici
Diagnostik Kupplung
Diagnostic

Flat Face
Innesti Faccia Piana
Flachdichtend
Clapet a Face Plat

Multifaster
Multiconnessioni
Multikupplungen
Multifaster



VF

VFB

ISO A - ISO B - Standard
 ISO A - ISO B - Standard
 ISO A - ISO B - Standard
 ISO A - ISO B - Standard

Agriculture
 Agricoltura
 Aüsführung Agritechnik
 Agriculture

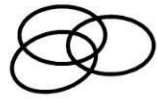
Accessories - Accessori - Zubehör - Accessoires

Size Base BG Taille		Dust protections Tappi Protezione Staubschutzteile Capuchons		Dust protections Tappi Protezione Staubschutzteile Capuchons		Seal Kits Guarnizioni di ricambio Ersatzdichtungen Joints	Package Confezione Packungseinheit Coils
mm	inch.	Part Number Codice Articolo Artikelnummer Désignation	Colour Colore Farbe Couleur	Part Number Codice Articolo Artikelnummer Désignation	Colour Colore Farbe Couleur		
10	3/8"			TFVF			

Screw Together
 Innesti a Vite
 Schraubkupplungen
 A Visser

Check Valves
 Valvole Unidirezionali
 Rückschläventile
 Clapet Anti-retour

Diagnostic
 Diagnostici
 Diagnostik Kupplung
 Diagnostic

Flat Face
 Innesti Faccia Piana
 Flachdichtend
 Clapet à Face Plat

Multifaster
 Multiconnessioni
 Multikupplungen
 Multifaster

Thread Filetto Anschluss Filetage

