

GRLBRQS - zawór kątowy dławiąco-zwrotny na dolicie*

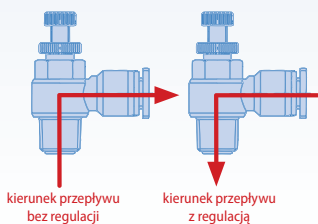
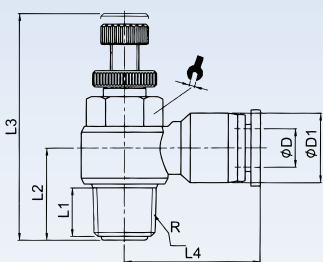

Kod zamówieniowy	ØD	R	L1	L2	L3 _(max)	L4	ØD1	↻
GRLBRQS M54	4	M5	3.5	12	32	20.5	11.5	8
GRLBRQS 184		R1/8	6.4	14	42	23.5	11.5	12
GRLBRQS 144		R1/4	10	18	48	25.5	11.5	14
GRLBRQS M56	6	M5	3.5	12	32	22	13.5	8
GRLBRQS 186		R1/8	6.4	14	42	23.5	13.5	12
GRLBRQS 146		R1/4	10	18	48	25.4	13.5	14
GRLBRQS 386		R3/8	11.4	20.5	53	29.5	13.5	19
GRLBRQS 126	8	R1/2	14	25.5	61	32.5	13.5	24
GRLBRQS 188		R1/8	6.4	14.5	42	26.5	15	12
GRLBRQS 148		R1/4	10	19	48	28.9	15	14
GRLBRQS 388		R3/8	11.4	20.5	53	29.8	15	19
GRLBRQS 128	10	R1/2	14	25.5	61	32.5	15	24
GRLBRQS 1810		R1/8	6.4	17.5	42	30.3	19	12
GRLBRQS 1410		R1/4	10	20	48	32.6	19	14
GRLBRQS 3810		R3/8	11.4	22.5	53	33	19	19
GRLBRQS 1210	12	R1/2	14	25.5	61	36	19	24
GRLBRQS 1412		R1/4	10	20	48	33.5	21.5	14
GRLBRQS 3812		R3/8	11.4	24	53	35.5	21.5	19
GRLBRQS 1212		R1/2	14	30	61	36.5	21.5	24

*elementy mogą być używane tylko z powietrzem

RQSDRV - zawór prosty dławiąco-zwrotny*

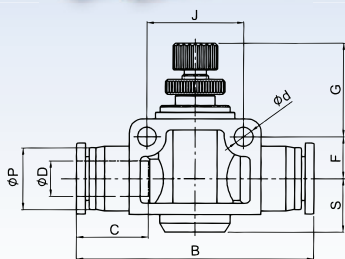

Kod zamówieniowy	ØD	ØP	B	C	G	F	S	Ød	J
RQSDRV 4	4	10.5	40.5	14.5	16	6.5	6.5	3.2	14
RQSDRV 6	6	12.5	48.7	15.5	25.5	8.5	11	4.3	20
RQSDRV 8	8	14	54.4	16.5	25	9.5	12	4.3	22
RQSDRV 10	10	18	64.3	19.5	29.5	10.5	12.5	4.3	26
RQSDRV 12	12	20.6	74.6	21	27.5	13	16	4.3	32

*elementy mogą być używane tylko z powietrzem