

RQSL - złącze kątowe z gwintem zewnętrznym

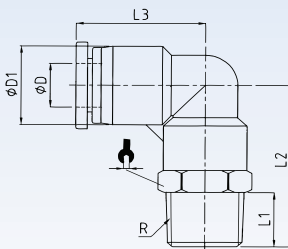

Kod zamówieniowy	ΦD	R	L1	L2	L3	$\Phi D1$	\curvearrowright
RQSL M54	4	M5	3.5	21.3	19	11.5	10
RQSL M64		M6	4	21.8	19	11.5	10
RQSL 184		R1/8	7.5	23.8	19	11.5	10
RQSL 144		R1/4	9.5	26.8	19	11.5	14
RQSL 384		R3/8	10.5	28.3	19	11.5	17
RQSL M56	6	M5	3.5	21.7	19.2	13.5	12
RQSL M66		M6	4	22.2	19.2	13.5	12
RQSL 186		R1/8	7.5	24.2	19.2	13.5	12
RQSL 146		R1/4	9.5	26.7	19.2	13.5	14
RQSL 386		R3/8	10.5	28.2	19.2	13.5	17
RQSL 126	R1/2	13.5	31.7	19.2	13.5	21	
RQSL 188	8	R1/8	7.5	27.5	22.5	15	14
RQSL 148		R1/4	9.5	29.5	22.5	15	14
RQSL 388		R3/8	10.5	31	22.5	15	17
RQSL 128		R1/2	13.5	34.5	22.5	15	21
RQSL 1810	10	R1/8	7.5	32.3	27.8	19	17
RQSL 1410		R1/4	9.5	34.3	27.8	19	17
RQSL 3810		R3/8	10.5	35.3	27.8	19	17
RQSL 1210		R1/2	13.5	38.8	27.8	19	21
RQSL 1812	12	R1/8	7.5	33.5	29.5	21.5	21
RQSL 1412		R1/4	9.5	36	29.5	21.5	21
RQSL 3812		R3/8	10.5	37	29.5	21.5	21
RQSL 1212		R1/2	13.5	40	29.5	21.5	21
RQSL 3814	14	R3/8	10.5	40.5	30.5	23.5	22
RQSL 1214		R1/2	13.5	43.5	30.5	23.5	22
RQSL 3816	16	R3/8	10.5	44	33	26.5	24
RQSL 1216		R1/2	13.5	47	33	26.5	24

RQSL - złącze kątowe z gwintem zewnętrznym z uszczelką NBR

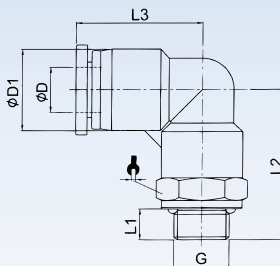

Kod zamówieniowy	ΦD	G	L1	L2	L3	$\Phi D1$	\curvearrowright
RQSL 184G	4	G1/8	5.5	24.3	19	11.5	14
RQSL 144G		G1/4	7.5	26.8	19	11.5	17
RQSL 186G	6	G1/8	5.5	24.2	19.2	13.5	14
RQSL 146G		G1/4	7.5	26.7	19.2	13.5	17
RQSL 386G		G3/8	7.5	27.2	19.2	13.5	20
RQSL 126G		G1/2	10	29.7	19.2	13.5	24
RQSL 188G	8	G1/8	5.5	27	22.5	15	14
RQSL 148G		G1/4	7.5	29.5	22.5	15	17
RQSL 388G		G3/8	7.5	30	22.5	15	20
RQSL 128G		G1/2	10	32.5	22.5	15	24
RQSL 1810G	10	G1/8	5.5	31.8	27.8	19	17
RQSL 1410G		G1/4	7.5	34.3	27.8	19	17
RQSL 3810G		G3/8	7.5	34.3	27.8	19	20
RQSL 1210G		G1/2	10	37.8	27.8	19	24
RQSL 1812G	12	G1/8	5.5	33.5	29.5	21.5	21
RQSL 1412G		G1/4	7.5	36	29.5	21.5	21
RQSL 3812G		G3/8	7.5	36	29.5	21.5	21
RQSL 1212G		G1/2	10	39	29.5	21.5	24
RQSL 3814G	14	G3/8	7.5	39	30.5	23.5	22
RQSL 1214G		G1/2	10	42.5	30.5	23.5	24
RQSL 3816G	16	G3/8	7.5	42.5	33	26.5	24
RQSL 1216G		G1/2	10	44.5	33	26.5	24