



Nominal Diameter

5,5 = 25 mm<sup>2</sup>

RECTUS Series



14KA

actual size

**Technical Description**

Robust brass coupling. Numerous connection options. Preferred application: compressed air technology and water connections.

**Advantages**

Single handed operation. Plug design optimised through greater insert depth.

**Working Pressure**

PB = 35 bar, maximum static working pressure with safety factor of 4 to 1.

**Interchangeability**

RECTUS 22  
ARO 210  
PARKER 50  
CEJN 300  
ORION 44510  
JWL 552 + JWL 532  
various Swiss Products

**Working Temperature\***

-20°C up to +100°C (NBR)  
-40°C up to +120/150°C (EPDM)  
-15°C up to +200°C (FKM)  
depending on the medium.

\*At a temperature below -20°C and above +100°C special seals are available on request.

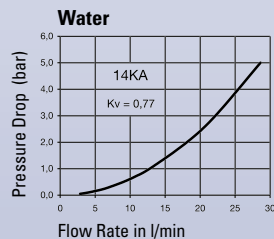
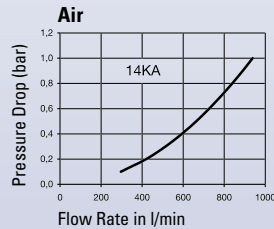
**Chart**

You will find the following alternative versions in our current catalogue on page:

► Safety Self-Venting P. 270

**Material****Coupling**

Back Body  
Valve Body  
Sleeve  
Valve  
Spring and Locking Ring  
Pins  
Seals

**Standard**

Brass  
Brass  
Brass  
Brass  
AISI 301  
AISI 420  
NBR

**Nickel Plated**

Brass, Nickel Plated  
Brass, Nickel Plated  
Brass, Nickel Plated  
Brass  
AISI 301  
AISI 420  
NBR

**Plug****Plug**

Steel Hardened, Nickel Plated or  
Brass and Brass, Nickel Plated

**Couplings****RECTUS Series 14KA**

	Connection A	Hex SW	L mm	D mm	L1 mm	L2 mm	Hex1 SW1	B mm	G mm	Version	Part Number	DS
<p><b>Male Thread</b></p>	G 1/4	22	43	25	9					Standard	14KA AW13 MPX	■
										Nickel Plated	14KA AW13 MPN	■
	G 3/8	22	43	25	9					Standard	14KA AW17 MPX	■
										Nickel Plated	14 KA AW17 MPN	■□
<p><b>Female Thread</b></p>	G 1/2	22	46	25	12					Standard	14KA AW21 MPX	■
										Nickel Plated	14KA AW21 MPN	■□
	G 1/4	22	43	25	9					Standard	14KA IW13 MPX	■
										Nickel Plated	14KA IW13 MPN	■
	G 3/8	22	43	25	9					Standard	14KA IW17 MPX	■
										Nickel Plated	14KA IW17 MPN	■□
	G 1/2	24	46	25	12					Standard	14KA IW21 MPX	■
										Nickel Plated	14KA IW21 MPN	■□

DS = Delivery Status: ■ in stock

■□ on short call

□ medium term delivery

# Couplings

# RECTUS Series 14KA

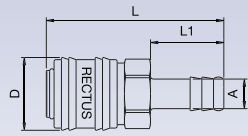

Hose Barb

Connection A	Hex SW	L mm	D mm	L1 mm	L2 mm	Hex1 SW1	B mm	G mm	Version	Part Number	DS
6 mm	21	60	25	25					Standard	14KA TF06 MPX	■
									Nickel Plated	14KA TF06 MPN	■□
8 mm	21	60	25	25					Standard	14KA TF08 MPX	■
									Nickel Plated	14KA TF08 MPN	■□
9 mm	21	60	25	25					Standard	14KA TF09 MPX	■
									Nickel Plated	14KA TF09 MPN	■□
10 mm	21	60	25	25					Standard	14KA TF10 MPX	■
									Nickel Plated	14KA TF10 MPN	■□
13 mm	21	60	25	25					Standard	14KA TF13 MPX	■
									Nickel Plated	14KA TF13 MPN	■□

# Plugs

# RECTUS Series 22SF

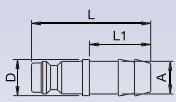

Hose Barb

Connection A	Hex SW	L mm	D mm	L1 mm	L2 mm	Hex1 SW1	B mm	G mm	Version	Part Number	DS
6 mm		49	12	25					Standard	22SF TF06 SXN	■
									Brass	22SF TF06 MXX	■
									Nickel Plated	22SF TF06 MXN	■□
8 mm		49	12	25					Standard	22SF TF08 SXN	■
									Brass	22SF TF08 MXX	■
									Nickel Plated	22SF TF08 MXN	■□
10 mm		49	12	25					Standard	22SF TF10 SXN	■
									Brass	22SF TF10 MXX	■
									Nickel Plated	22SF TF10 MXN	■□
13 mm		49	15	25					Standard	22SF TF13 SXN	■
									Brass	22SF TF13 MXN	■
									Nickel Plated	22SF TF13 MXN	■□

# Plugs

# RECTUS Series 22SF

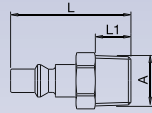

Male Thread

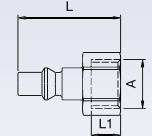

Female Thread

Connection A	Hex SW	L mm	D mm	L1 mm	L2 mm	Hex1 SW1	B mm	G mm	Version	Part Number	DS
R 1/4	14	41		12					Standard	22SF AK13 SXN	■
									Brass	22SF AK13 MXX	■
									Nickel Plated	22SF AK13 MXN	■
R 3/8	17	41		12					Standard	22SF AK17 SXN	■
									Brass	22SF AK17 MXX	■
									Nickel Plated	22SF AK17 MXN	■
R 1/2	22	46		17					Standard	22SF AK21 SXN	■
									Brass	22SF AK21 MXX	■
									Nickel Plated	22SF AK21 MXN	■
G 1/4	17	35		9					Standard	22SF IW13 SXN	■
									Brass	22SF IW13 MXX	■
									Nickel Plated	22SF IW13 MXN	■
G 3/8	19	35		10					Standard	22SF IW17 SXN	■
									Brass	22SF IW17 MXX	■
									Nickel Plated	22SF IW17 MXN	■□

DS = Delivery Status: ■ in stock

■□ on short call

□ medium term delivery