

Nominal Diameter

5

 = 20 mm²

RECTUS Series



17KA

actual size



Technical Description

English profile industrial coupling with UltraFlo technology, giving high flow performance. Specially suited to compressed air applications. Brass/steel design developed for industry. Compact dimensions and single handed operation make it suitable for numerous applications.

Advantages

Single handed operation. Small dimensions, light weight. High flow valve.

Working Pressure

PB = 35 bar, maximum static working pressure with safety factor 4 to 1.

Interchangeability

SCHRADER NW 5

Working Temperature*

-20°C up to +100°C (NBR)
-40°C up to +120/150°C (EPDM)
-15°C up to +200°C (FKM)
depending on the medium.

*At a temperature below -20°C and above +100°C special seals are available on request.

Chart

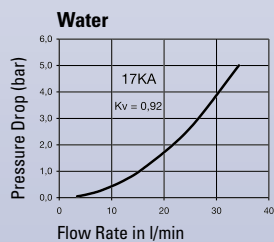
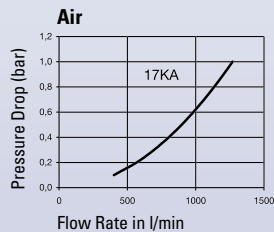

Material

Coupling

Back Body
Valve Body
Sleeve
Valve
Inner Sleeve
Spring Plate
Spring and Locking Ring
Locking Balls
Seals

Standard

Brass, Nickel Plated
Steel Hardened and Nickel Plated
Steel Hardened and Nickel Plated
Brass
Brass
Brass
AISI 303
AISI 420
NBR

Plug

Plug

Steel Hardened, Nickel Plated

Couplings

RECTUS Series 17KA

	Connection A	Hex SW	L mm	D mm	L1 mm	L2 mm	Hex1 SW1	B mm	G mm	Version	Part Number	DS
<p>Male Thread</p>	R 1/4	19	63	23	12					Standard	17KA AK13 SPN	■
	R 3/8	19	62	23	12					Standard	17KA AK17 SPN	■
	R 1/2	22	63	23	17					Standard	17KA AK21 SPN	■
<p>Female Thread</p>	G 1/4	19	58	23	9					Standard	17KA IW13 SPN	■
	G 3/8	19	57	23	9					Standard	17KA IW17 SPN	■
	G 1/2	24	60	23	12					Standard	17KA IW21 SPN	■□

DS = Delivery Status: ■ in stock

■□ on short call

□ medium term delivery

Couplings

RECTUS Series 17KA

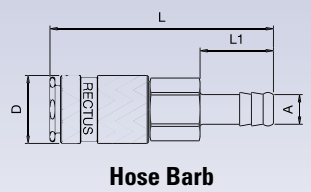

Hose Barb

Connection A	Hex SW	L mm	D mm	L1 mm	L2 mm	Hex1 SW1	B mm	G mm	Version	Part Number	DS
6 mm	19	76	23	25					Standard	17KA TF06 SPN	■
8 mm	19	76	23	25					Standard	17KA TF08 SPN	■□
10 mm	19	76	23	25					Standard	17KA TF10 SPN	■
13 mm	7	76	23	25					Standard	17KA TF13 SPN	■

Plugs

RECTUS Series 17KA

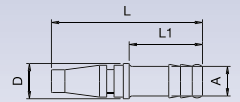

Hose Barb

Connection A	Hex SW	L mm	D mm	L1 mm	L2 mm	Hex1 SW1	B mm	G mm	Version	Part Number	DS
6 mm		58	12	25					Standard	17SF TF06 SXN	■
8 mm		52	12	25					Standard	17SF TF08 SXN	■
10 mm		52	12	25					Standard	17SF TF10 SXN	■

Plugs

RECTUS Series 17KA

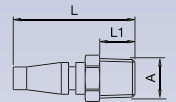

Male Thread

Connection A	Hex SW	L mm	D mm	L1 mm	L2 mm	Hex1 SW1	B mm	G mm	Version	Part Number	DS
R 1/8	11	37		9					Standard	17SF AK10 SXN	■
R 1/4	14	42		12					Standard	17SF AK13 SXN	■

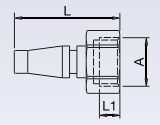

Female Thread

G 1/8	14	33		7					Standard	17SF IW10 SXN	■
G 1/4	17	36		9					Standard	17SF IW13 SXN	■

DS = Delivery Status: ■ in stock

■□ on short call

□ medium term delivery