

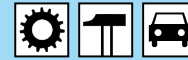

Nominal Diameter

5,5 = 25 mm²

RECTUS Series



18KA

actual size

**Technical Description**

ISO 6150 C industrial coupling with UltraFlo technology. Robust design. The steel sleeve counters oscillating forces. System has limited use for liquids (steel sleeve/zinc die cast valve).

Dust Caps (P. 325)

for coupling Part.-No. SK23S

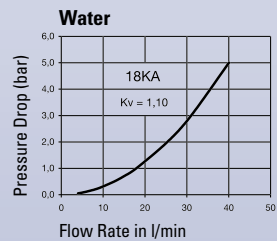
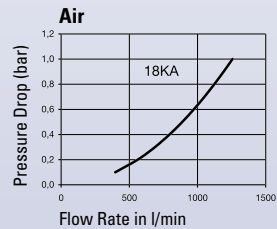
**Chart**

You will find the following alternative versions in our current catalogue on page:

► Safety Self-Venting P. 272

Advantages

Single handed operation.
Innovative valve technology.
Plug design optimised through greater insert depth. High flow valve.

Interchangeability

CEJN 291
OETIKER
ISO 6150 C

Working Pressure

PB = 35 bar, maximum static working pressure with safety factor of 4 to 1.

Working Temperature*

-20°C up to +100°C (NBR)
-40°C up to +120/150°C (EPDM)
-15°C up to +200°C (FKM)
depending on the medium.

*At a temperature below -20°C and above +100°C special seals are available on request.

Material**Coupling**

Back Body
Valve Body
Sleeve
Valve
Inner Sleeve
Spring Plate
Spring and Locking Ring
Locking Balls
Seals

Standard

Brass, Nickel Plated
Brass, Nickel Plated
Steel Hardened, Nickel Plated
Zinc Diecasting, Nickel Plated
Brass
Brass
AISI 301
AISI 420
NBR

Plug**Plug**

Steel Hardened, Nickel Plated

Couplings**RECTUS Series 18KA**

	Connection A	Hex SW	L mm	D mm	L1 mm	L2 mm	Hex1 SW1	B mm	G mm	Version	Part Number	DS
<p>Male Thread</p>	R 1/4	19	63	23	12					Standard	18KA AK13 MPN	■
	R 3/8	19	62	23	12					Standard	18KA AK17 MPN	■ □
	R 1/2	22	63	23	17					Standard	18KA AK21 MPN	■
<p>Female Thread</p>	G 1/4	19	58	23	9					Standard	18KA IW13 MPN	■
	G 3/8	19	57	23	9					Standard	18KA IW17 MPN	■
	G 1/2	24	60	23	12					Standard	18KA IW21 MPN	■ □

DS = Delivery Status: ■ in stock

■ □ on short call

□ medium term delivery

Couplings

RECTUS Series 18KA

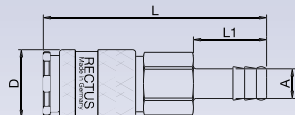

Hose Barb

Connection A	Hex SW	L mm	D mm	L1 mm	L2 mm	Hex1 SW1	B mm	G mm	Version	Part Number	DS
6 mm	19	76	23	25					Standard	18KA TF06 MPN	■
8 mm	19	76	23	25					Standard	18KA TF08 MPN	■□
10 mm	19	76	23	25					Standard	18KA TF10 MPN	■□
13 mm	19	76	23	25					Standard	18KA TF13 MPN	■□

Plugs

RECTUS Series 18KA

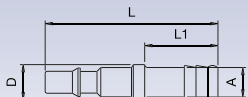

Hose Barb

Connection A	Hex SW	L mm	D mm	L1 mm	L2 mm	Hex1 SW1	B mm	G mm	Version	Part Number	DS
6 mm		59	12	25					Standard	18SF TF06 SXN	■
8 mm		59	12	25					Standard	18SF TF08 SXN	■
10 mm		59	12	25					Standard	18SF TF10 SXN	■

Plugs

RECTUS Series 18KA

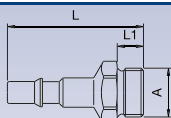

Male Thread

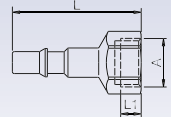

Female Thread

Connection A	Hex SW	L mm	D mm	L1 mm	L2 mm	Hex1 SW1	B mm	G mm	Version	Part Number	DS
G 1/4	17	41		9					Standard	18SF AW13 SXN	■
G 3/8	19	41		9					Standard	18SF AW17 SXN	■□
G 1/4	17	43		9					Standard	18SF IW13 SXN	■
G 3/8	19	44		9					Standard	18SF IW17 SXN	■

DS = Delivery Status:

■ in stock

■□ on short call

□ medium term delivery