



Nominal Diameter

5,5 = 25 mm²

RECTUS Series



24KA

actual size

**Technical Description**

1/4" Industrial brass coupling conforming to ISO 6150B and US Mil. Spec 4109. Notable for brass mass design and corresponding sleeve design. Hardened steel plug counters vibrations and effects of external forces.

Advantages

Single handed operation.

Working Pressure

PB = 35 bar, maximum static working pressure with safety factor of 4 to1.

Working Temperature*

-20°C up to +100°C (NBR)
-40°C up to +120/150°C (EPDM)
-15°C up to +200°C (FKM)
depending on the medium.

*At a temperature below -20°C and above +100°C special seals are available on request.

Interchangeability

RECTUS 23
RECTUS 1400/1423
TEMA 1400
INDUSTR. INTERCHANGE 1/4"
US-MIL-SPEC-C-4109,
ISO 6150 B
CEJN 310, HANSEN 3000,
FASTER, GROMELLE 600
PARKER 20 1/4" + 30 1/4"
JWL 521 + JWL 531

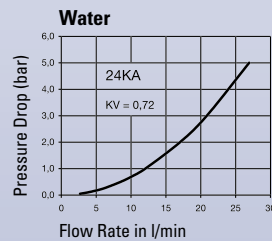
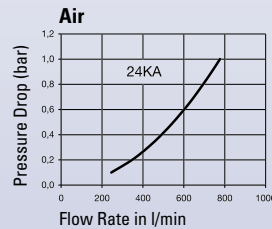
Chart

You will find the following alternative versions in our current catalogue on page:

► Safety Self-Venting

P. 276

Material**Coupling**

Back Body
Valve Body
Sleeve
Valve
Spring and Locking Ring
Pins
Seals

Standard

Brass
Brass
Brass
Brass
AISI 301
AISI 420
NBR

Nickel Plated

Brass, Nickel Plated
Brass, Nickel Plated
Brass, Nickel Plated
Brass
AISI 301
AISI 420
NBR

Plug**Plug**

Steel Hardened, Nickel Plated or Brass

Couplings**RECTUS Series 24KA**

	Connection A	Hex SW	L mm	D mm	L1 mm	L2 mm	Hex1 SW1	B mm	G mm	Version	Part Number	DS
<p>Male Thread</p>	G 1/4	22	43	25	9					Standard	24KA AW13 MPX	■
										Nickel Plated	24KA AW13 MPN	■□
	G 3/8	22	43	25	9					Standard	24KA AW17 MPX	■
										Nickel Plated	24KA AW17 MPN	■□
<p>Female Thread</p>	G 1/4	22	43	25	11					Standard	24KA IW13 MPX	■
										Nickel Plated	24KA IW13 MPN	■□
	G 3/8	22	43	25	9					Standard	24KA IW17 MPX	■
										Nickel Plated	24KA IW17 MPN	■□
G 1/2	22	46	25	12					Standard	24KA IW21 MPX	■	
									Nickel Plated	24KA IW21 MPN	■□	

DS = Delivery Status:

■ in stock

■□ on short call

□ medium term delivery

Couplings

RECTUS Series 24KA

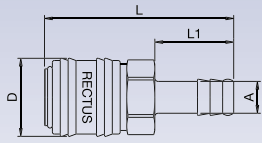

Hose Barb

Connection A	Hex SW	L mm	D mm	L1 mm	L2 mm	Hex1 SW1	B mm	G mm	Version	Part Number	DS
6 mm	21	60	25	25					Standard	24KA TF06 MPX	■
8 mm	21	60	25	25					Standard	24KA TF08 MPX	■
									Nickel Plated	24KA TF08 MPN	■□
9 mm	21	60	25	25					Standard	24KA TF09 MPX	■
10 mm	21	60	25	25					Standard	24KA TF10 MPX	■
13 mm	21	60	25	25					Standard	24KA TF13 MPX	■

Plugs

RECTUS Series 23SF

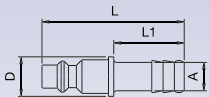

Hose Barb

Connection A	Hex SW	L mm	D mm	L1 mm	L2 mm	Hex1 SW1	B mm	G mm	Version	Part Number	DS
4 mm		51	14	25					Brass, Nickel P.	23SF TF04 MXN	■□
6 mm		51	14	25					Standard	23SF TF06 SXN	■
									Brass	23SF TF06 MXX	■
8 mm		51	14	25					Standard	23SF TF08 SXN	■
									Brass	23SF TF08 MXX	■□
9 mm		51	14	25					Standard	23SF TF09 SXN	■
									Brass	23SF TF09 MXX	■
10 mm		51	14	25					Standard	23SF TF10 SXN	■
									Brass	23SF TF10 MXX	■
13 mm		51	15	25					Standard	23SF TF13 SXN	■

Plugs

RECTUS Series 23SF

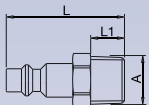

Male Thread

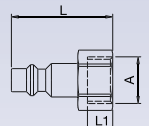

Female Thread

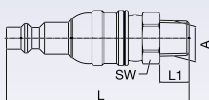

Flex Joint, Male Thread

Connection A	Hex SW	L mm	D mm	L1 mm	L2 mm	Hex1 SW1	B mm	G mm	Version	Part Number	DS
R 1/8	13	39		9					Standard	23SF AK10 SXN	■
R 1/4	14	42		12					Standard	23SF AK13 SXN	■
G 1/4									Brass	23SF AW13 MXX	■
R 3/8	17	42		12					Standard	23SF AK17 SXN	■
									Brass	23SF AW17 MXX	■
R 1/2	22	48		17					Standard	23SF AK21 SXN	■
G 1/8	14	36		9					Standard	23SF IW10 SXN	■
									Brass	23SF IW13 MXX	■
G 1/4	17	36		9					Standard	23SF IW13 SXN	■
									Brass	23SF IW13 MXX	■
G 3/8	19	36		9					Standard	23SF IW17 SXN	■
									Brass	23SF IW17 MXX	■
G 1/2	24	39		12					Standard	23SF IW21 SXN	■
R 1/4	17	68		11					Standard	23FA AK13 SPN	■

DS = Delivery Status:

■ in stock

■□ on short call

□ medium term delivery