



Nominal Diameter

7,8 = 48 mm²

RECTUS Series



25KS

actual size

**Technical Description**

Safety coupling with UltraFlo technology. High flow performance. Notable for robust design and steel sleeve used with large pneumatic consumers. Additional safety locking system. This safety lock prevents unintentional disconnection. To disconnect, the plug must first be pushed further into the coupling before it can be unlocked.

Advantages

Quality coupling with small dimensions and high flow rates. Safety locking system. Double profiled plug design against wear of material during operation.

Working Temperature*

-20°C up to +100°C (NBR)
-40°C up to +120/150°C (EPDM)
-15°C up to +200°C (FKM)
0°C up to +316°C (FFKM)
depending on the medium.

*At a temperature below -20°C and above +100°C special seals are available on request.

Working Pressure

PB = 35 bar (Brass)
PB = 70 bar (with steel body and steel seal), maximum static working pressure with safety factor of 4 to 1.

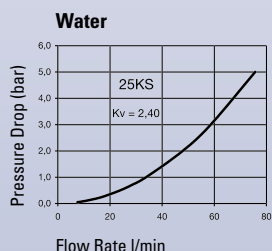
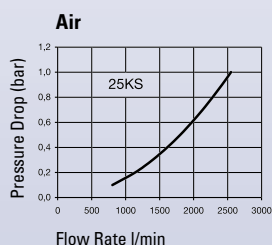
Chart

You will find the following alternative versions in our current catalogue on page:

- ▶ Safety Double Shut-off P. 268
- ▶ Safety Self-Venting P. 280
- ▶ Coded Systems P. 297
- ▶ Brass/Steel P. 73
- ▶ Stainless Steel P. 180

Material Coupling

	Standard	Brass	Brass, Nickel Pl.
Back Body	Brass	Brass	Brass, Nickel Pl.
Valve Body	Steel, Nickel Pl.	Brass	Brass, Nickel Pl.
Sleeve	Steel Hardened, Nickel Plated	Brass	Brass, Nickel Pl.
Valve	Brass	Brass	Brass
Spring and Lock Ring	AISI 301	AISI 301	AISI 301
Locking Balls	AISI 420	AISI 420	AISI 420
Seals	NBR	NBR	NBR
Distance Sleeve	Brass	Brass	Brass
Spring Plate	Brass	Brass	Brass

Plug

	Standard	Brass	Brass, Nickel Pl.
Plug	Steel Hardened, Zinc-Plated	Brass	Brass, Nickel Pl.

Couplings**RECTUS Series 25KS**

Connection A	Hex SW	L mm	D mm	L1 mm	L2 mm	Hex1 SW1	B mm	G mm	Version	Part Number	DS
R 1/4	19	60	23	12					Standard	25KS AK13 SPN	■ □
									Brass	25KS AK13 BPX	■ □
									Brass, Nickel Pl.	25KS AK13 BPN	■ □
R 3/8	19	60	23	12					Standard	25KS AK17 SPN	■ □
									Brass	25KS AK17 BPX	■ □
									Brass, Nickel Pl.	25KS AK17 BPN	■ □
R 1/2	22	61	23	17					Standard	25KS AK21 SPN	■ □
									Brass	25KS AK21 BPX	■ □
									Brass, Nickel Pl.	25KS AK21 BPN	■ □

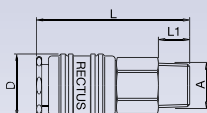
**Male Thread**

DS = Delivery Status:

■ in stock

■ □ on short call

■ □ medium term delivery

Couplings

RECTUS Series 25KS

Safety

Low Pressure

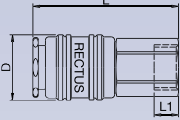
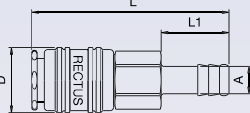
	Connection A	Hex SW	L mm	D mm	L1 mm	L2 mm	Hex1 SW1	B mm	G mm	Version	Part Number	DS	
 <p>Female Thread</p>	G 1/4	19	56	23	10					Standard	25KS IW13 SPN	■	
										Brass	25KS IW13 BPX	■	
										Brass, Nickel Pl.	25KS IW13 BPN	■	
	G 3/8	19	55	23	9						Standard	25KS IW17 SPN	■
											Brass	25KS IW17 BPX	■
											Brass, Nickel Pl.	25KS IW17 BPN	■
	G 1/2	24	58	23	12						Standard	25KS IW21 SPN	■
 <p>Hose Barb</p>	6 mm	19	74	23	25					Standard	25KS TF06 SPN	■	
	8 mm	19	74	23	25						Standard	25KS TF08 SPN	■
											Brass	25KS TF08 BPX	■
											Brass, Nickel Pl.	25KS TF08 BPN	■
	9 mm	19	74	23	25						Standard	25KS TF09 SPN	■
											Brass	25KS TF09 BPX	■
											Brass, Nickel Pl.	25KS TF09 BPN	■
	10 mm	19	74	23	25						Standard	25KS TF10 SPN	■
											Brass	25KS TF10 BPX	■
											Brass, Nickel Pl.	25KS TF10 BPN	■
	13 mm	19	74	23	25						Standard	25KS TF13 SPN	■
											Brass	25KS TF13 BPX	■
											Brass, Nickel Pl.	25KS TF13 BPN	■

Plugs

RECTUS Series 25KS

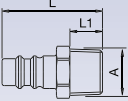
	Connection A	Hex SW	L mm	D mm	L1 mm	L2 mm	Hex1 SW1	B mm	G mm	Version	Part Number	DS	
 <p>Male Thread</p>	R 1/8	13	33		9					Standard	25SS AK10 SXZ	■	
	R 1/4	14	37		12					Standard	25SS AK13 SXZ	■	
	G 1/4	17	33		9						Brass	26SS AW13 MXX	■
											Brass, Nickel Pl.	26SS AW13 MXN	■
	R 3/8	17	37		12					Brass	25SS AK17 SXZ	■	
	R 1/2	22	43		17						Standard	25SS AK21 SXZ	■

DS = Delivery Status: ■ in stock

■ on short call

■ medium term delivery

Plugs

RECTUS Series 25KS

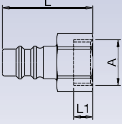
	Connection A	Hex SW	L mm	D mm	L1 mm	L2 mm	Hex1 SW1	B mm	G mm	Version	Part Number	DS
 <p>Female Thread</p>	G 1/4	17	33		9					Standard	25SS IW13 SXZ	■
	G 3/8	19	33		9					Standard	25SS IW17 SXZ	■
	G 1/2	24	36		12					Standard	25SS IW21 SXZ	■

Plugs

RECTUS Series 25KS

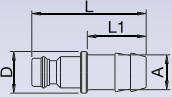
	Connection A	Hex SW	L mm	D mm	L1 mm	L2 mm	Hex1 SW1	B mm	G mm	Version	Part Number	DS
 <p>Hose Barb</p>	6 mm		48	12	25					Standard	25SS TF06 SXZ	■
	8 mm		48	12	25					Standard	25SS TF08 SXZ	■
			48	12	25					Brass, Nickel Pl.	26SS TF08 MXN	■
	9 mm		48	12	25					Standard	25SS TF09 SXZ	■
	10 mm		48	12	25					Standard	25SS TF10 SXZ	■
	13 mm		48	15	25					Standard	25SS TF13 SXZ	□

DS = Delivery Status:

■ in stock

□ on short call

□ medium term delivery