



Nominal Diameter

6

 = 30 mm²

RECTUS Series



31KA

actual size

**Technical Description**

Steel industrial coupling with high flow due to UltraFlo technology. Widely used in the Scandinavian market. Specially suited to use with gaseous media in industry.

Dust Caps (P. 325)

for coupling
for plug

Part.-No. SK23S
Part.-No. SK12S

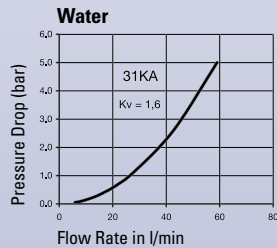
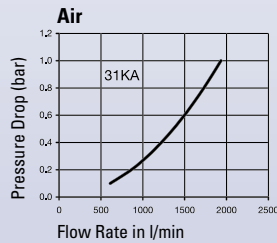
**Chart****Advantages**

Single handed operation. Extremely high flow performance from optimum valve design. High flow valve.

Interchangeability

TEMA 1300 (single shut-off)
Cejn 303

Working Pressure

PB = 35 bar, maximum static working pressure with safety factor of 4 to1.

Working Temperature*

-20°C up to +100°C (NBR)
-40°C up to +120/150°C (EPDM)
-15°C up to +200°C (FKM)
depending on the medium.

*At a temperature below -20°C and above +100°C special seals are available on request.

Material**Coupling**

Back Body
Valve Body
Sleeve
Valve
Spring Plate
Spring and Locking Ring
Locking Balls
Seals

Standard

Brass, Nickel Plated,
Steel, Black Nitrided
Brass, Nickel Plated
Brass
Brass
AISI 301
AISI 420
NBR

Plug

Plug

Steel Hardened,
Zinc Chromatized

Couplings

RECTUS Series 31KA

	Connection A	Hex SW	L mm	D mm	L1 mm	L2 mm	Hex1 SW1	B mm	G mm	Version	Part Number	DS
<p>Male Thread</p>	R 1/4	19	58	22	12					Standard	31KA AK13 SPN	■
	R 3/8	19	56	22	12					Standard	31KA AK17 SPN	■□
	R 1/2	23	57	26	14					Standard	31KA AK21 SPN	■□
<p>Female Thread</p>	G 1/4	19	55	22	11					Standard	31KA IW13 SPN	■□
	G 3/8	20	55	22	10					Standard	31KA IW17 SPN	■

DS = Delivery Status: ■ in stock

■□ on short call

□ medium term delivery

Couplings

RECTUS Series 31KA

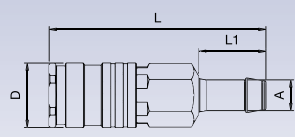

Hose Barb

Connection A	Hex SW	L mm	D mm	L1 mm	L2 mm	Hex1 SW1	B mm	G mm	Version	Part Number	DS
6 mm	19	78	22	23					Standard	31KA TF06 SPN	■ □
8 mm	19	78	22	23					Standard	31KA TF08 SPN	■ □
10 mm	19	78	22	23					Standard	31KA TF10 SPN	■ □
13 mm	19	77	22	24					Standard	31KA TF13 SPN	■

Plugs

RECTUS Series 31KA

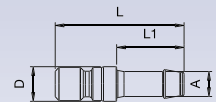

Hose Barb

Connection A	Hex SW	L mm	D mm	L1 mm	L2 mm	Hex1 SW1	B mm	G mm	Version	Part Number	DS
6 mm		44	12	23					Standard	31SF TF06 SXZ	■
8 mm		44	12	23					Standard	31SF TF08 SXZ	■
10 mm		44	12	24					Standard	31SF TF10 SXZ	■
13 mm		47	12	24					Standard	31SF TF13 SXZ	■ □

Plugs

RECTUS Series 31KA

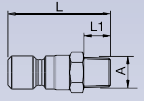

Male Thread

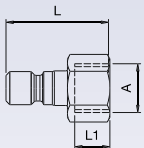

Female Thread

Connection A	Hex SW	L mm	D mm	L1 mm	L2 mm	Hex1 SW1	B mm	G mm	Version	Part Number	DS
R 1/8	13	35		9					Standard	31SF AK10 SXZ	■
R 1/4	14	38		12					Standard	31SF AK13 SXZ	■
R 3/8	17	38		12					Standard	31SF AK17 SXZ	■ □
R 1/2	22	40		14					Standard	31SF AK21 SXZ	■
G 1/8	13	32		8,5					Standard	31SF IW10 SXZ	■
G 1/4	16	36		10					Standard	31SF IW13 SXZ	■
G 3/8	20	36		10					Standard	31SF IW17 SXZ	■

DS = Delivery Status: ■ in stock

■ on short call

■ □ medium term delivery