

## RQSG - złącze proste z gwintem zewnętrznym do klucza imbusowego

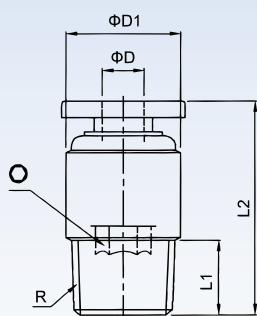

Kod zamówieniowy	$\Phi D$	R	L1	L2	$\Phi D1$	O
RQSG M54I	4	M5	3.5	20.3	10	2
RQSG M64I		M6	4	20.8	10	2
RQSG 184I		R1/8	7.5	20	10	3
RQSG 144I		R1/4	9.5	18	14	3
RQSG M56I	6	M5	3.5	21	12	2
RQSG M66I		M6	4	21	12	2
RQSG 186I		R1/8	7.5	20.5	12	4
RQSG 146I		R1/4	9.5	22.5	14	4
RQSG 386I		R3/8	10.5	20.5	17	4
RQSG 126I		R1/2	13.5	24.5	21	4
RQSG 188I	8	R1/8	7.5	25.5	14	5
RQSG 148I		R1/4	9.5	24.5	14	5
RQSG 388I		R3/8	10.5	21.5	17	6
RQSG 128I		R1/2	13.5	25.5	21	6
RQSG 1810I	10	R1/8	7.5	29.5	17	5
RQSG 1410I		R1/4	9.5	31	17	6
RQSG 3810I		R3/8	10.5	28.5	17	8
RQSG 1210I		R1/2	13.5	26.5	21	8
RQSG 1812I	12	R1/8	7.5	31	21	5
RQSG 1412I		R1/4	9.5	33	21	6
RQSG 3812I		R3/8	10.5	30	21	8
RQSG 1212I		R1/2	13.5	32.5	21	8

## RQSF - złącze proste z gwintem wewnętrznym

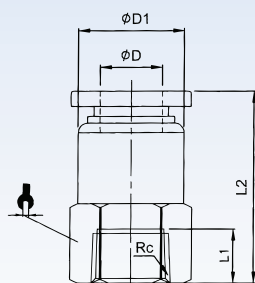

Kod zamówieniowy	$\Phi D$	Rc	L1	L2	$\Phi D1$	↻
RQSF M54	4	M5	5.5	21	10	10
RQSF M64		M6	6	21.5	10	10
RQSF 184		Rc1/8	8.5	24	10	14
RQSF 144		Rc1/4	11	26.5	10	17
RQSF M56	6	M5	5.5	21.5	12	12
RQSF M66		M6	6	22	12	12
RQSF 186		Rc1/8	8.5	24.5	12	14
RQSF 146		Rc1/4	11	27	12	17
RQSF 386		Rc3/8	12	28	12	21
RQSF 126		Rc1/2	14	30	12	24
RQSF 188	8	Rc1/8	8.5	26	14	14
RQSF 148		Rc1/4	11	28.5	14	17
RQSF 388		Rc3/8	12	29.5	14	21
RQSF 128		Rc1/2	14	31.5	14	24
RQSF 1810	10	Rc1/8	8.5	29.5	17	17
RQSF 1410		Rc1/4	11	32.7	17	17
RQSF 3810		Rc3/8	12	33	17	21
RQSF 1210		Rc1/2	14	35.7	17	24
RQSF 1812	12	Rc1/8	8.5	31	20	21
RQSF 1412		Rc1/4	11	33.5	20	21
RQSF 3812		Rc3/8	12	34.5	20	21
RQSF 1212		Rc1/2	14	36.5	20	24